

OREGON WOOD WORKS

TEN PRINCIPLES OF GOOD DESIGN

In the 1970's Dieter Rams redefined the parameters for successful mass-produced (and craft) design by creating his Ten Principles of Good Design. These tenets continue to inspire makers around the world:

#7.

Good design is long-lasting.

It avoids being fashionable and therefore never appears antiquated.

Unlike fashionable design, it lasts many years - even in today's throwaway society.

IN THIS ISSUE

Next Program	1
MEET-UP	6
Intro-Guild Show	7 & 8
Education	
<i>Classes</i>	9
<i>Saturday Academy</i>	9
<i>SIGs</i>	10
Comm. Service	
Volunteer of Month	11
Cut Offs	12
Pushsticks	13

NEXT PROGRAM:

A VISIT FROM DOWNES GUITARS

TUESDAY, JUNE 18

**SOCIAL TIME 6PM, OFFICAL MEETING 7PM
MULTNOMAH ARTS CENTER (MAC)**

There is music in the air this summer and the Guild is welcoming back Kieran Downes of Downes Guitars. He visited the Guild many years ago so this will be a great opportunity for both new members and old to see what innovations he's come up with.

Kieran will share his beginnings and his process of building, from wood selections to final set-up process of developing electric guitars. He will also be bringing along lots of pictures of his design and building process.

Kieran has been musically inspired from a very young age and started building guitars with pre-made bodies and necks over a decade ago. That quickly developed into creating bodies and necks from scratch with his own style. This lead to the launching of Downes Guitars in 2013.

See you at the Multnomah Arts Center (MAC) on June 18. Social time starts at 6pm with the general meeting starting at 7pm. The board meeting will be held in room 7 at the MAC from 5:30-6:30 for anyone who would like to attend.

If there are any questions please contact CJ Marquardt at cj@cjmwoodcraft.com or 503-267-1930.



MARK YOUR CALENDAR: FUTURE GUILD MEETINGS

July Meeting: Tuesday the 16th
Presentation on the Albany Carousel

August Meeting: Tuesday the 20th
Annual Guild Picnic at Summerlake Park

September Meeting: Tuesday the 17th
Currently Open - maybe 'Bring your jigs show and tell'?

October Meeting: Tuesday the 22nd
Mary May Carving Presentation

November Meeting: Tuesday the 19th
Terra Firma Design NW, Tom and Jennifer, teachers from Port Townsend, Marquetry and leaded glass focusing on furniture and lighting pieces.

December Meeting: Thursday the 12th
Annual Guild Holiday Party at the Multnomah Arts Center

NOTES FROM THE GUILD PRESIDENT



Steve Poland

Hello Woodworkers, I hope most of you got to enjoy Gathering of the Guilds, and our recent Intraguild Show. There was a LOT of very impressive design and craftsmanship on display. As usual it was inspiring and humbling.

I spent most of May traveling in North Carolina, a state with a

deep history in craft and furniture making, and then capped it off at my son Matt's MBA graduation in Berkeley. So instead of bloviating I'd just like to share some more inspiration with images of work we encountered just during this month. I apologize to you and the makers that I don't have maker identification for all of these but I think you will appreciate what they have accomplished.

Mint Uptown Museum in Charlotte, NC:

1. Turned wood bowls – Virginia Dotson, Garry Knox Bennett, Hayley Smith
2. Susan Point – Salish – Salmon Spawning Run
3. Peter Chapman - puzzle horse & penguin
4. Laura Kishimoto – Yumi Chair II
5. (Apple table) Brent Skidmore, Kurt Nielsen, Brad Nelson, Michael Werner Jamie Russell
6. Joseph Walsh studio furniture bent wood.
7. Stacked cabinets
8. Low table & tall case



continued on [page 3](#)

Notes from Guild President...continued from page 2

North Carolina Craft Gallery at Brookstown:

- 9. Maple & cherry plant stand
- 10. Carved maple sideboard
- 11. Chair with suspended block seat & back
- 12. Sculptured cabinet
- 13. End table, suspended block rocker, side table
- 14. Modern desk
- 15. Half ellipse table
- 16. Carved & figured maple highboy



13.



9.



10.



14.



11.



15.



12.



16.

continued on [page 4](#)

Notes from Guild President...continued from page 3

Winston-Salem Historic Village:

- 17. Moravian chair - dry fit
- 18. Moravian chair finished (same style we saw in Prague)
- 19. Shaving horse

Mordecai House, Raleigh NC:

- 20. Traditional rocker, spiral arms



Notes from Guild President...continued from page 4

Kitty Hawk NC:

21. "an early aircraft"

San Francisco Designer Showcase – at the Koshland Home 1904:

22. Modern take on dark wood library

23. Sculptured modern sideboard



The Guild of Oregon Woodworkers is...

..., a group of amateur and professional woodworkers committed to developing our craftsmanship.

Our Mission: To promote the craft of woodworking to the woodworkers of today and tomorrow.

Our Vision: A community of woodworkers that provide significant opportunities to develop, practice, enhance, and share woodworking skills.

The Guild offers many benefits for members, including:

- ◆ Monthly programs
- ◆ Monthly newsletter
- ◆ Weekly Volunteer Special Interest Groups (SIGs)
- ◆ An education program to help members develop woodworking skills through a variety of hands-on and lecture classes
- ◆ Sponsor discounts
- ◆ Woodworking shows (such as Gathering of the Guilds)
- ◆ Network of business partners.
- ◆ A woodworking shop
- ◆ A network of friends and opportunities to volunteer and make a difference in our community
- ◆ Free and low cost community programs to join in learning woodworking skills through special interest groups, community build, & estate sales volunteering

What you can do for the Guild

- ◆ Volunteer your time to contribute, assist, organize, lead, teach, etc.
- ◆ Take a class
- ◆ Contribute your knowledge

For more information see the Guild website or visit the shop.

Guild Shop - 7634 SW 34th St, Portland, OR 97219

Guildoforegonwoodworkers.org

WELCOME NEW MEMBERS

Welcome to our newest **23** members. We're happy to have you with us and hope you'll make a regular appearance at the monthly program, contribute articles to the newsletter, and volunteer in other ways. Say hello at the next meeting so we can get to know you. New member orientation is 6:30-6:45 at each monthly meeting.

Raquel Abreo, Ken Baker, Jerry Boone, Julie Boyles, Brad Brahe, Andrew Brahe, Jillian Burke, Jen Bybee, Kody Conrad, Bill Dresselhaus, Nicole Gable, Ryan Griggs, Bruce Hamlin, John Hanna, Adam Littman, Joe Munsinger, Paige Osburn, Ben Riggsby, Mark Rios, MacKenzie Ross, Ryan Stewart, Cari Tucker, Mike Wode

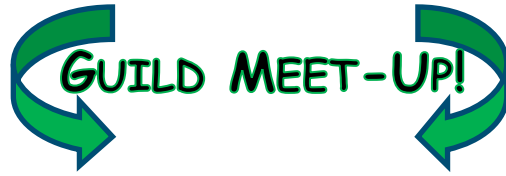

Many of us who have joined the Guild recognize that woodworking can be a lonely avocation. It's fun to get together with other woodworker's to swap stories, share successes, and failures, and to ask questions. Come join the fun at the next MEET-UP ...

MONDAY, JUNE 3 - 11:30AM

Salvador Molly's

1523 SW Sunset Blvd. In Hillsdale near the shop.

MONDAY JULY 1 - 11:30AM

Radio Room

1101 NE Alberta St. Portland 97211

The monthly Meet-Ups are held on the first Monday of the month and try to visit all parts of Portland. The goal is to allow members to get to know each other and develop friendships. Attendees order off the menu and pay on their separate check.

All the Meet-Ups gather at 11:30 am, but late comers are always welcome. Everyone in the Guild is invited.

Pacific Northwest Tool Collectors 16th Annual Flea Market - June 1

at Bill Racine's home
12780 SW 231st PLACE
HILLSBORO, OR. 97123
(503) 628-1488

billstoolsbc19@yahoo.com

Find more info about the group at
<https://pntc.website/pntc-meeting-schedule>



12th Annual Intra-Guild Show

CJ Marquardt

Last month we had the opportunity to see what our fellow Guild members have been up to at the 12th Annual Intra-Guild Show. There were numerous pieces covering a variety of woodworking styles, all showcasing the wonderful skills of our members. There was a bit of everything including a functioning crossbow, guitar, fine furniture and a number of carvings both by hand and CNC. Ribbons were awarded to a number of projects along with a very special Best in Show Award.

As some may be aware, Bob Oswald, our late editor-in-chief, was the inspiration and drive behind the re-institution of this annual event. To honor Bob's passion for the craft, we are privileged to be able to introduce the Bob Oswald Best in Show Award. Congratulations to **John Sutter** and his bridge table for winning the Bob Oswald Best in Show award and to all of our other award winning pieces!

Keep creating and plan on entering next years show!



John Sutter wins Advanced - 2nd place plus Bob Oswald Best-in-Show Award.



*Ruth Warbington
Beginner - 1st Place*



*Tim Moore
Intermediate -
1st Place*



*Jerry Boone -
Carved Chalice*

continued on page 8

12th Annual Intra-Guild Show



*John Sheridan -
Advanced - 3rd Place*



*Jerry Boone -
Intermediate - 2nd Place*



*Jim Spitzer -
Intermediate - 3rd Place*



Roger Crooks



Bob Hargrave

GUILD CLASSES - *See the Guild website for registration and details. Contact the Class Coordinator with questions. All classes are held at the Guild Shop unless otherwise specified. 7634 SW 34th St, Portland, OR*

Designing a Monogram

Chuck Rinehart

Jun 8, 9-1

Class Fee: \$50

Multnomah Art Center

Class Coordinator: Larry Wade

This class will focus exclusively on designing a monogram that you can then carve into a project on your own, or perhaps wait for a hands-on workshop (to be scheduled) in which the instructor will guide you in the carving.

Build a Garden Bench and Planter Set

Asa Christiana

Jul 20, 9-5

Class Fee: \$180

Class Coordinator: Steve Anderly

Spend a Saturday at the Guild shop and go home with a lovely Japanese-style garden bench and two matching planters. We will have plenty of assistants on hand to help or guide if needed, so come with whatever skills you already have. You should be able to finish the project and perhaps master some new skills along the way.

See the Guild website for registration and details. Contact the Class Coordinators with questions. All classes are held at the Guild Shop unless otherwise specified. 7634 SW 34th St, Portland, OR 97219

AFFILIATE UPCOMING CLASSES

See their websites for more details and offerings.

ANVIL ACADEMY

Knife Making

Jun 4, 9, 11, and 22

Instructor: Chuck Cook

Leaf Making Blacksmith Class

Jun 18

Instructor: Dan Bowyer

NORTHWEST WOODWORKING STUDIO

Chair Design Strategy Workshop

Aug 2-4

Instructor: Gary Rogowski

**SATURDAY ACADEMY
WOODWORKING FOR GIRLS**

Saturday Academy, a local STEM Education non-profit, is offering a girls-only woodworking class taught by local Guild woodworker **Eddee Edson**. More information about the class - and a link to register - is below. There is also a co-ed carpentry class taught by **Dan Silver-nail**, Franklin HS woodworking teacher. Two girls are currently enrolled; the class needs about 5 students total to run.

Woodworking for Girls, Grades 8-12

Franklin High School

August 12 - 16, 9 AM - 12 PM, Mon. - Fr.

Girl power meets power tools!

Create a stool or toolbox! Explore material, designs, and joinery. Learn woodworking techniques like marking and measuring. Use Japanese hand saws and power tools. Take a project from lines on paper to physical reality.

Construction: Carpentry, Grades 6-12

Franklin High School

July 29 - August 2, 9 AM - 12 PM, Mon. - Fri.

What can you shape and make from wood? Learn the craft and creativity of carpentry that awaits you in the woodshop. Learn to operate power tools including a jointer, planer, drill press and more. Take your project from lines on paper to a physical reality.

Katie Gibbs, M. Ed.

Classes and Camps Coordinator

katie@saturdayacademy.org

503.200.5866 (direct)



Doug Drake

Special Interest Groups (SIG)

These groups have discussions and hands-on demonstrations. The SIG groups meet in the Guild Shop.

PROFESSIONAL SIG

We are working on starting a Special Interest Group (SIG) for Professionals. We might meet in person sometimes, and electronically at other times, to discuss issues of interest. Some topics we have in mind are things like:

- ◆ How do I move from a serious hobbyist woodworker to a “real” business?
- ◆ Setting up a business entity and business licenses.
- ◆ When are bonding and insurance needed and how do I get these?
- ◆ Defining a core bread-and-butter product strategy.
- ◆ Developing and expanding clientele.
- ◆ What about employees?
- ◆ Who are good wholesale suppliers.
- ◆ Developing a high-end wood finishing strategy.
- ◆ Producing a product efficiently.
- ◆ When can CNC be an advantage, and how do I get started?
- ◆ Pricing my products and services.
- ◆ Getting repeat business.

If you are interested in participating, please send email to Vince Corbin at vinceanddiane@gmail.com

WOMEN’S SIG

Next Meeting: Thursday, June 6 (first Thursday of each month) in the Guild Shop at 6pm (We will be there by 5 if you’d like to come help set up)

Topic: Building a workbench for your shop.

Lead: Eddee Edson - mseddeee@gmail.com

CNC SIG

When: Second Thursday of the Month

Next Meeting: June 13 - 6pm

Where: Multnomah Art Center

If you are a beginner or advanced CNC user or want to know how to get started, the CNC SIG is for you.

Lead: Craig Jones - cjones3106@gmail.com
503-975-7541

See the Guild website for details.

HAND TOOL SIG

Next Meeting: Wednesday, June 26, 2019 at 6:30:00 pm to 9:00 pm in the Guild Shop

Topic: Japanese hand tools, how should they be used and other tips for better woodworking

Lead: Ken Hall -- ken@old-scholls.com

Chip Webster will lead an open forum including:

- ◆ a discussion about using Japanese pull saws; selection, care, sharpening
- ◆ demonstrate and practice the sawing techniques Taeho Kwon showed us
- ◆ demonstrate and practice the walking technique to place bench chisels on a layout line (Western chisels and Japanese chisels)
- ◆ demonstrate and practice paring techniques with Japanese paring chisels
- ◆ discussion about Japanese hand planes - tips Taeho Kwon shared with the class

After Chip's demonstration and discussion, you will get an opportunity to practice your skills using Japanese hand tools.

Participants are encouraged to bring their Japanese saws, chisels and hand planes. Chip and Ken do not have any Japanese hand planes, so please bring any that you have.

As always, you are encouraged to bring any hand tools for show and tell.

Please register on the Guild website if you plan to attend so that we can get an idea of how many people will be attending.

If you have any questions, contact Ken Hall [<ken@old-scholls.com>](mailto:ken@old-scholls.com)



Tracy Whalen



This award is given to highlight individuals who put in an extraordinary time and effort support the Guild. The Guild wouldn't exist if not for all our volunteers. Thank you to all.

MEET CAROL BOYD

Gig Lewis

Carol has been a member of the Guild for almost 1 1/2 years and has been very active with her membership.

She has been a member of the Toy Team for over a year and has helped to get the Toy portion of the annex sorted out and organized. She was very active in the Gathering of the Guilds, both in making toys and in helping the Guild have a successful show. She was also very much involved with organization of the Intra-Guild Show.

Carol is retired from the Forest Service and lives in the Beaverton area. We are fortunate to have a volunteer like Carol. Tell her thanks when you see her or get to know her.



**Volunteer of the Month-
May 2019 CAROL BOYD**



SHOWS COMMITTEE CHAIR: NEEDED

Board Position. This is the person who organizations and events managers contact to work on bringing the Guild to their event. Such events as Art in the Pearl, Clackamas County Fair, and Multnomah Days.

The responsibilities of the Shows Chair are, to help find and coordinate volunteers for the event and delegate the tasks needed to pull off an event.

This is another very social position within the Guild, and leads to knowing a lot of fellow Guild members. Working with the past chairs to transition into this position is proposed.

Learn while helping lead!

Let's talk!

Steve Poland polandpdx@gmail.com.



Note the really cool truck in the lower right is all Carol's work, and she made all those firetruck cabs with the 3 lights on top!

LETTER TO THE GUILD

May 21, 2019

Gig.

Carol and I returned recently from a two week trip to New England. We love that part of the country and use whatever excuse we can muster to go for a visit. This trip coincided with the Fine Woodworking Live conference in South-bridge, MA April 26-28.

I enjoyed the opportunity to attend the event and to listen to people who I have met through books, magazines, and videos over the past years that I have pursued woodworking.

It was interesting that many of the presenters have a connection to the Guild of Oregon Woodworkers such as Garrett Hack, Michael Fortune, Christopher Schwarz, and Miguel Gomez-Ibanez. I was able to meet and visit briefly with each of these men, all of who spoke highly of their relationship and experiences with the Guild.

I attended all of the breakouts I could and came to realize that the basics that I have learned through mentors, in the Guild, are rock on!! What the Guild has created is more than fantastic.

Thank you for all the help you have provided me.

Herb Drew



Jake Bradley

ROCKLER GARAGE SALE

Once a year, Rockler sponsors a Garage Sale at their Beaverton Store.

This always brings out woodworkers from around the area to sell the odds and ends from their shop. The Guild always supports this Sale because of our relationship with Rockler.

Plan to come early for the best deals.

When: June 15th

Setup begins at 8:00am and the sale goes no later than 2:00pm. Most sellers leave earlier.

Feel free to bring any items you would like to sell. There are no charges for table space or selling fees.

**NOTE IF YOU PLAN TO SELL,
BRING PLENTY OF CHANGE.**

HOW TIGHT IS TOO TIGHT

Gig Lewis

All of us are trying to get the joints in projects tight so that we can take pride in our work. Getting two pieces of wood to match up perfectly for a tight joint is a goal that we all have. This is where we should focus on things being tight.

Many of our machines are self-tightening. That causes multiple problems with machines being tightened too much. The routers, table saws, spindle sanders, and the chop saw are self-tightening. We only need to get them snug with the wrenches that are used. If you tighten it too much, the machine is designed to tighten it more and so it gets overtightened to a degree that might put the machine out of business.

The Guild Shop

Someone using the Pantorouter tightened the collect so much that it broke the pin that keeps the bit in place. Someone has tightened the Oscillating spindle sanders so much that we cannot switch to the various sizes. Some of the blades on the SawStops are over tightened. We can do better. If you have a question check with the SA, Many members of the Guild are strong, and by habit over-tighten the machines. Please let the machines do the final tightening after you get it to the “Snug” position.

PUSHSTICKS

John Sheridan

Originally published, *Woodwork*, Dec. 2002 – pp. 74-75

The 10" tablesaw blade has a rim speed of 120mph; 176 feet per second. That is very fast. With 5.6 revolutions per second, a 50-tooth combination blade presents 280 carbide teeth every second and they are ready to cut anything and everything. A handy pushstick and good technique on a well-adjusted saw are your best protection against injury or accident.

Clarifying tablesaw ripping safety, from attitude to practice, is always challenging, but more so if the students have no prior experience with machinery. At the college where Brad Boggie and I teach I required one-semester "Introduction to Furniture" for the Interior Architecture Department, the students build a small table and a small floor or wall cabinet both within a framework called "Story Furniture," which is designed to develop communication skills as well.

What Brad and I try to do is inspire respect for the table-saw and its fast blade, and offer a technique for ripping material that protects the novice and reassures the experienced. First, we emphasize that "ripping" isn't just cutting forward; that what they are doing is going forward and sideways. The motion is a vector directed toward the far corner of the fence (1). Secondly, we explain that the paradox of the tablesaw rip is that the closer the pushstick is to the blade (and they must use a pushstick), the safer the cut. A push near the fence will roll the wood toward the blade, increasing the chance of a kick-back. The proper place for the pushstick is on the material being cut and just to the left of the center of the piece. In other words, as you look at the material to be cut, the pushstick should be closer to the blade, about 1/3 of the distance from the blade to the fence.

Lastly, the students learn to use the smaller fish-shaped stick in their left hand, always keeping it in front of the blade as the right hand stick goes all the way through to complete the cut.

Templates based on the drawings and photos make it easy for you to make your own pushsticks. Small variation in the appearance of the pushsticks in the photos reflect subtle changes that have been made in the design over time.

I use scrap 1/2" and 3/4" maple plywood. My standard layout module is a piece 9 1/4" x 11" with two large pushsticks penciled in and cut on the bandsaw. The tight middle curve is drilled out with a 1" bit before the cutting (2). When rough-cutting the blanks to be routed, guide the cut of the notched bottom by holding a straight piece of material in the other hand as an informal fence (3). A 3/8" 6-tpi band-saw blade works well; a tightly-guided 1/4" roundover bit. For making dozens of sticks at a time, I have fashioned a

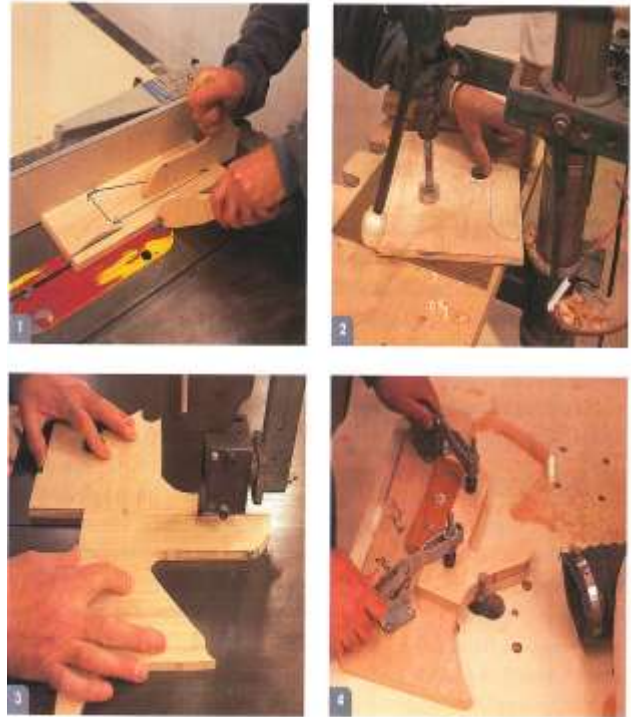

A good pair of pushsticks are a fundamental shop aid for safe and accurate cutting on the tablesaw. John's method is fast and cheap, which encourages replacing your old ones as they get used up

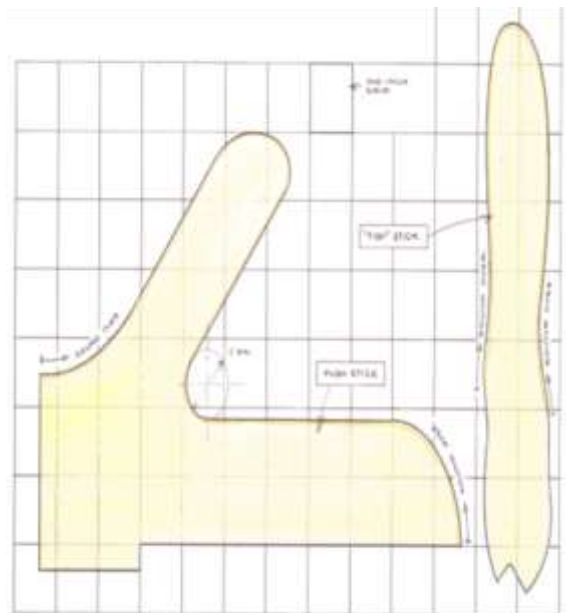

router jig (4). Using a spiral bit with a bottom bearing. The hold-downs are De-Sta-C0 #235-U.

After you make a few pushsticks for yourself, make a few more as gifts for friends or for a local school's woodworking program encourage safe techniques.

THE GUILD IS PROUD TO BE SPONSORED BY:

The Guild is grateful to be supported by numerous local businesses, our sponsors. Please patronize them when you can. Most offer some kind of discount to members, with some restrictions. We hope you will thank them for their support when you are at the cash register.



CARBIDE SAW
Sales & Sharpening

